

BRISTOL CITY COUNCIL

PUBLIC RIGHTS OF WAYS AND GREENS COMMITTEE

3 OCTOBER 2011

Report of: Commons Registration Authority

Title: Current applications for registration of land as town or village greens

Ward: Citywide

Officer Presenting Report: Anne Nugent, Senior Solicitor, Legal Services

Contact Telephone Number: 0117 9223424

RECOMMENDATION

To note the present position with regards Town or Village Green applications

Summary

This report contains a schedule of the present position with regards Town or Village Green applications duly made under the Commons Act 2006

The significant issues in the report are:

The present position with regards Town or Village Green applications

Policy

1. There are no specific policy implications arising from this report.

Consultation

2. Internal

Not applicable

3. External

Not applicable

Context

4. To update the Schedule of Town & Village Green Applications to show the current position

Proposal

5. None

Other Options Considered

6. None

Risk Assessment

7. None undertaken as no decision is being taken at this stage

Legal and Resources Implications

Legal

Each Application will have a separate report to Committee at the appropriate time.

Legal advice provided by : Anne Nugent , Senior Solicitor, Legal Services.

Financial

(a) **Revenue**

(b) **Capital**

There are no specific implications arising from this report.

Land

There are no specific implications arising from this report.

Personnel

Not applicable

Appendices

Appendix A – Schedule of the present position with regards Town or Village Green applications duly made under the Commons Act 2006

Appendix A (i) - Map of Whitchurch Park – Application No: 10

Appendix A (ii) - Map of Ashton Vale – Application No: 12

Appendix A (iii) - Map of Filwood Open Space – Application No: 14

Appendix A (iv) - Map of Grove Wood – Application No: 15

Appendix A (v) - Map of Okebourne Open Space – Application No: 16

Appendix A (vi) - Map of Wellington Hill Playing Fields – Application No: 18

Appendix A (vii) - Map of Bracey Drive, Frenchay – Application No: 19

Appendix A (viii) - Map of Higham Street Green - Application No: 20

Appendix A (ix) - Map of Elderberry Walk Open Space – Application No: 21

Appendix A (x) - Map of Stoke Lodge Playing Field – Application No: 24

Local Government (Access to Information) Act 1985

Background Papers:

Application papers available at the Council House, College Green.

Section 15 Commons Act 2006

Commons (Registration of Town or Village Greens) (Interim Arrangements) (England) Regulations 2007

21 September 2011

APPENDIX (8) A

Schedule of current Town or Village Green Applications that have been duly made.

Updated 08 September 2011.

Whitchurch Park (File No. JD5/363)

- **Application No:** 10
- **Date Application received:** 11 February 2008 (amended 4 August 2010)
- **Description of Application land:** The field, Whitchurch Park, Elmtree Park, The Green, Fortfield Green
- **Location of Application land:** Bounded roughly by Brier Leaze Road, Bamfield, Pinks Twist, Asda, Fortfield Road and Cranwell Road (Application Map Appendix No. A(i))
- **Applicant:** Elmtree Park Residents Association, John Button, Chair,
State of Application: Inspector's report recommended registration of part of the application land. Report to be considered by the Committee on 3 October 2011.

Filwood Park Open Space (File No. JD5/428)

- **Application No:** 14
- **Date Application received:** 12 November 2009
- **Description of Application land:** Filwood Park Open Space
- **Location of Application land:** Land bounded by Hengrove Way, Creswicke Road and Filwood Playing Fields (Application Map Appendix No. A(ii))
- **Applicant:** Mil Lusk
- **Landowner:** Urban Regeneration Agency
- **State of Application:** Inspectors report received. Inspector has issued instructions for further directions.

Ashton Vale (File No. JD5/386)

- **Application No:** 12
- **Date Application received:** 26 October 2009
- **Description of Application land:** Ashton Vale Fields
- **Location of Application land:** Ashton Vale Fields, adjoining North Somerset Boundary, Between Ashton Vale Drive Cul-de-sac and The Park and Ride (Application Map Appendix No. A(iii))
- **Applicant:** Mr Michael J Peters
- **Land owner:** Ashton Vale Project LLP, 70 Prince Street Bristol BS14HU
- **State of Application:** Committee decision to register part 16 June 2011. Registered on 26 July 2011.

Grove Wood (File No. JD5/379)

- **Application No:** 15
- **Date Application received:** 26 November 2009
- **Description of Application land:** Grove Wood
- **Location of Application land:** Woodland below Blackberry Hill Hospital next to River Frome, Stapleton Bristol (Application Map Appendix No. A(iv))

- **Applicant:** Snuff Mills Action Group C/O Mr Steve Micklewright,
- **Land owner:** The Rhino Group Ltd, 19 Downleaze, Bristol BS9 1LT
- **State of Application:** Inquiry opened 4 April 2011. Part heard. Inquiry completed 5 August 2011. Inspectors report awaited

Okebourne Open Space, Brentry (File No.JD5/435)

- **Application No:** 16
- **Date Application received:** 16 July 2010
- **Description of Application land:** Okebourne Park or Oakwood Park
- **Location of Application land:** Leading of Knole Lane and Chakes Hill Drive, Brentry BS10 (Application Map Appendix No. A(v))
- **Applicant:** Mr John Rich on behalf of the Friends of Okebourne Open Space
- **State of Application:** Statement of Objections received from Council. Response to Objections received from Applicants. CRA to issue Directions for next steps ie refer to the Committee

Wellington Hill Playing Fields (File No: JD5/438)

- **Application No:** 18
- **Date Application received:** 12 October 2010
- **Description of Application land:** Wellington Hill Playing Field
- **Location of Application land:** Wellington Hill, Horfield, Bristol (Application Map Appendix No. A(vi))
- **Applicant:** Mr Gavin Boby
- **State of Application:** Statement of Objection received . Response received. CRA to issue Directions for the next steps.

Bracey Drive, Frenchay (File No. JD5/434)

- **Application No:** 19
- **Date Application received:** 13 October 2010
- **Description of application land:** Green
- **Location of Application land:** Bordered by Frenchay Road, Long Close and Bracey Drive, Bristol BS16 (Application Map Appendix No. A(vii))
- **Applicant:** Mr Anthony Thomas
- **State of application:** Period for receipt of Statement of Objections expires on 30 September 2011. Statement of Objections received from the Council . Statement sent to Applicants for response.

Higham Street Green, (File No. JD5/441)

- **Application No:** 20
- **Date Application received:** 22 October 2010
- **Description of Application land:** Higham Street Green/Higham Street Open Space
- **Location of Application land:** Higham Street, Totterdown, Bristol (Application Map Appendix No. A(viii))
- **Applicant:** Ms Joanne Fisher
- **State of Application:** Statement of Objections received. Statement sent to Applicants for response.

Elderberry Walk Open Space (File No. JD5/446)

- **Application No:** 21
- **Date Application received:** 10 January 2011
- **Description of Application land:** Elderberry Walk Open Space
- **Location of Application land:** land on the south east side of Charlton Road, Southmead Bristol (Application Map Appendix No. A(ix))
- **Applicant:** Mrs Alison E. Devonshire
- **State of Application:** Statement of Objections received. Applicants have been asked to respond by early November 2011.

Stoke Lodge Playing Fields (file number JD5/450)

- **Application No:** 24
- **Date Application received:** 7 March 2011
- **Description of Application land:** Stoke Lodge Playing Fields,
- **Location of Application land:** Stoke Lodge Playing Fields, Shirehampton Road, Stoke Bishop, Bristol BS9 1BN. (Application Map Appendix No. A(x))
- **Applicant:** Mr David Mayer,
- **State of Application:** Notices served. Statement of Objections to be lodged by 18 November 2011.

JD5.349

21/09/11

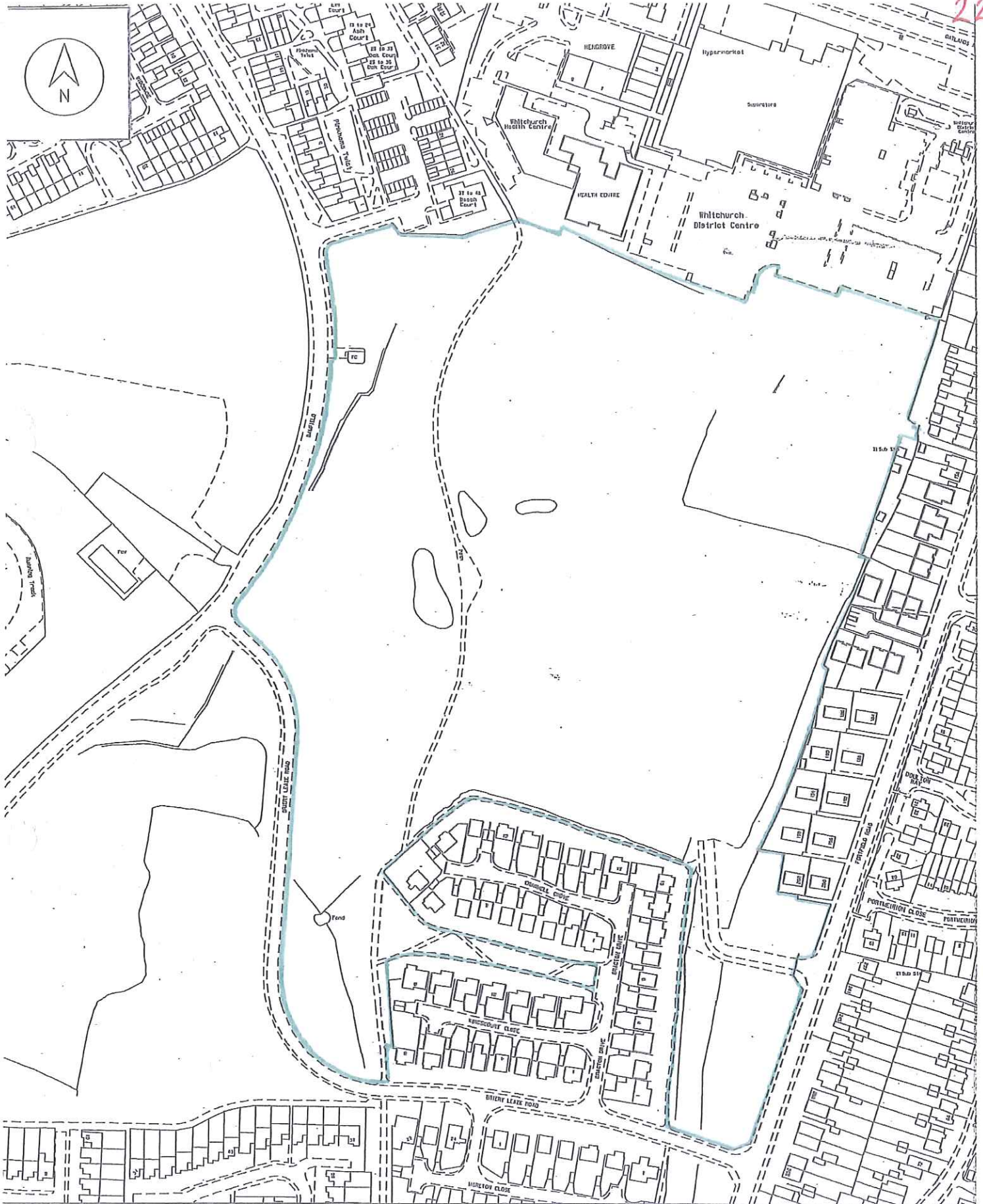

WHITCHURCH TVG
APPLICATION LAND
(AS AMENDED) SCALE 1:2500

MAP 'A'



Pinpoint property-related information
<http://maps.bristol.gov.uk>



OS (at Crown Copyright 2009. 100023406

0 20m

© Bristol City Council
16/02/2009 17:34:20

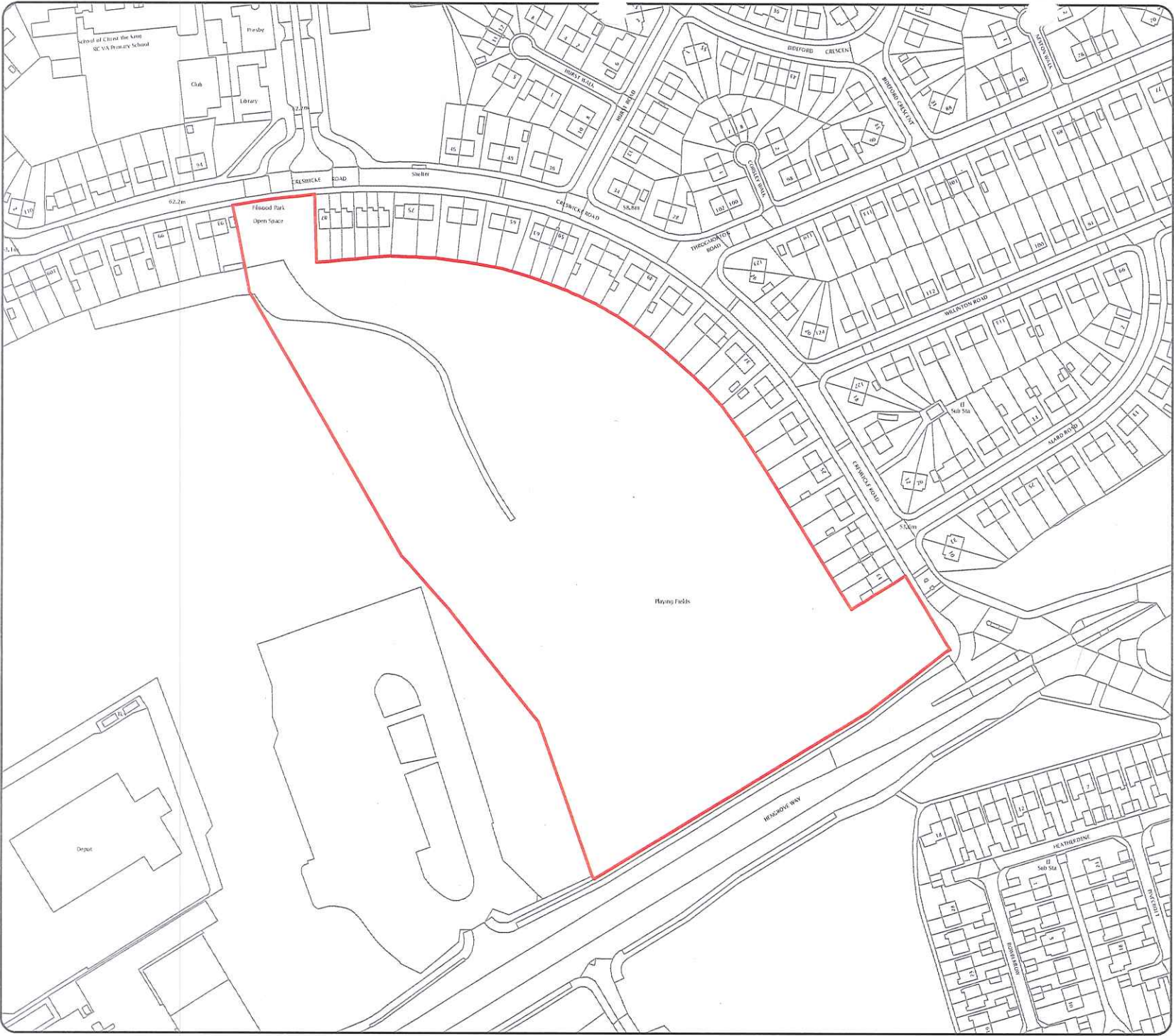

Filwood Park

This drawing is the property of Bristol City Council. All intellectual property rights including copyright are vested in Bristol City Council. Any unauthorised reproduction or electronic copying of this drawing could lead to a civil claim for damages and criminal prosecution. Bristol City Council does not warrant that this drawing is accurate unless it is an original drawing. Bristol City Council shall not be liable for any loss or damage howsoever caused if reliance is placed by any party on a reproduced drawing.

SITE PLAN : To ensure boundary accuracy, please refer to deeds.

This map is reproduced from Ordnance Survey material with the permission of Ordnance Survey on behalf of the Controller of Her Majesty's Stationery Office © Crown copyright. Unauthorised reproduction infringes Crown copyright and may lead to prosecution or civil proceedings. Bristol City Council. 100023406. 2009.

CORPORATE PROPERTY

Plan No : 1
 Prop ID Ref : n/a
 Polygon Ref : n/a
 Scale : 1:2,500
 Date : 16th Dec 2009



RESOURCES DIRECTORATE

Floor 7, B Bond, Smeaton Road, Bristol BS1 6EE.
 Tel : (0117) 903 7620 Fax : (0117) 903 7617
 Will Godfrey, Strategic Director of Resources.

Filwood Park Appendix A (iii)

Land Registry
Official copy of
title plan

Title number BL64497
Ordnance Survey map reference ST82763E
Scale 1:2500 reduced from 1:1250
Administrative area City of Bristol



© Crown Copyright. Reproduced by Land Registry. No reproduction in whole or in part is permitted without the prior written permission of Ordnance Survey. License Number 100025216

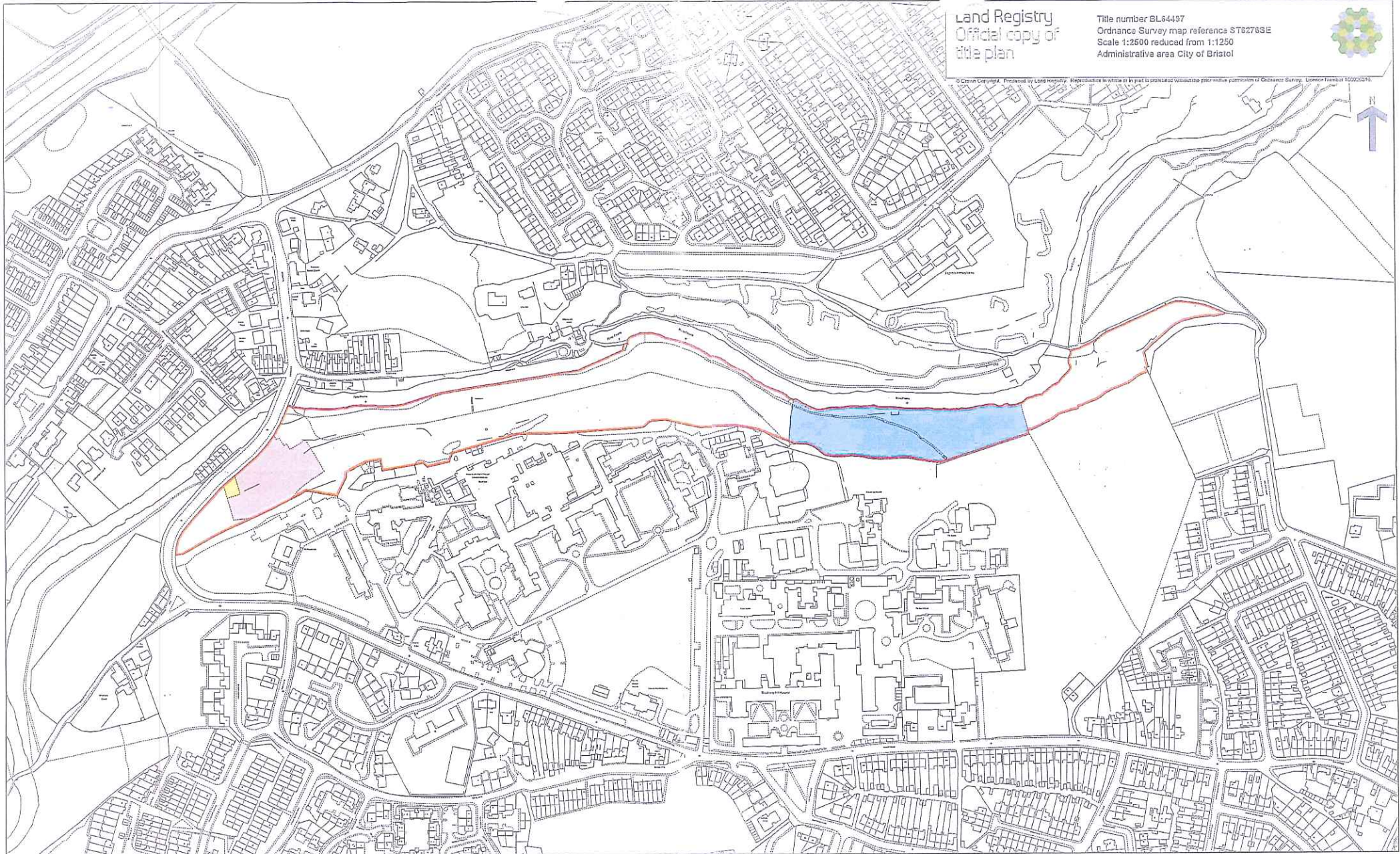

This official copy issued on 3 February 2010 shows the state of this title plan on 2 February 2010 at 16:11:51. It is admissible in evidence to the same extent as the original (s.67 Land Registration Act 2002).
This title plan shows the general position, not the exact line, of the boundaries. It may be subject to distortions in scale. Measurements scaled from this plan may not match measurements between the same points on the ground. See Land Registry Public Guide 19 - Title Plans and Boundaries.
This title is dealt with by Land Registry, Gloucester Office.

Grove Wood Appendix no: A (iv)

Land Registry
Official copy of
title plan

Title number **BL110040**
Ordnance Survey map reference **ST5879SW**
Scale **1:2500**
Administrative area **CITY OF BRISTOL**



© Crown Copyright. Produced by Land Registry. Reproduction in whole or in part is prohibited without the prior written permission of Ordnance Survey. Licence Number 100026316.

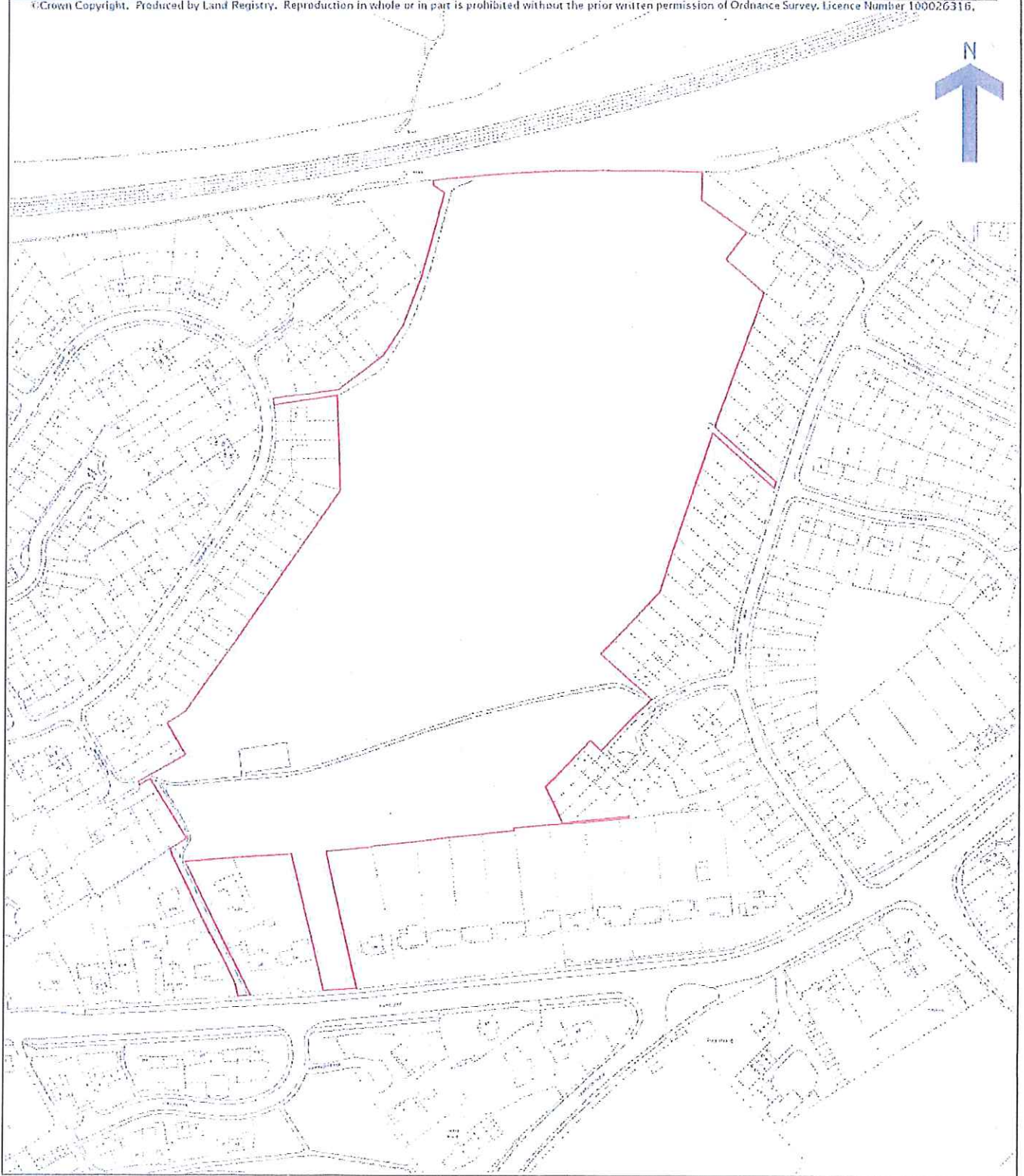

Land Registry
Current title plan

Title number BL108167
Ordnance Survey map reference ST5976NW
Scale 1:1250
Administrative area CITY OF BRISTOL



© Crown Copyright. Produced by Land Registry. Reproduction in whole or in part is prohibited without the prior written permission of Ordnance Survey. Licence Number 100026316.

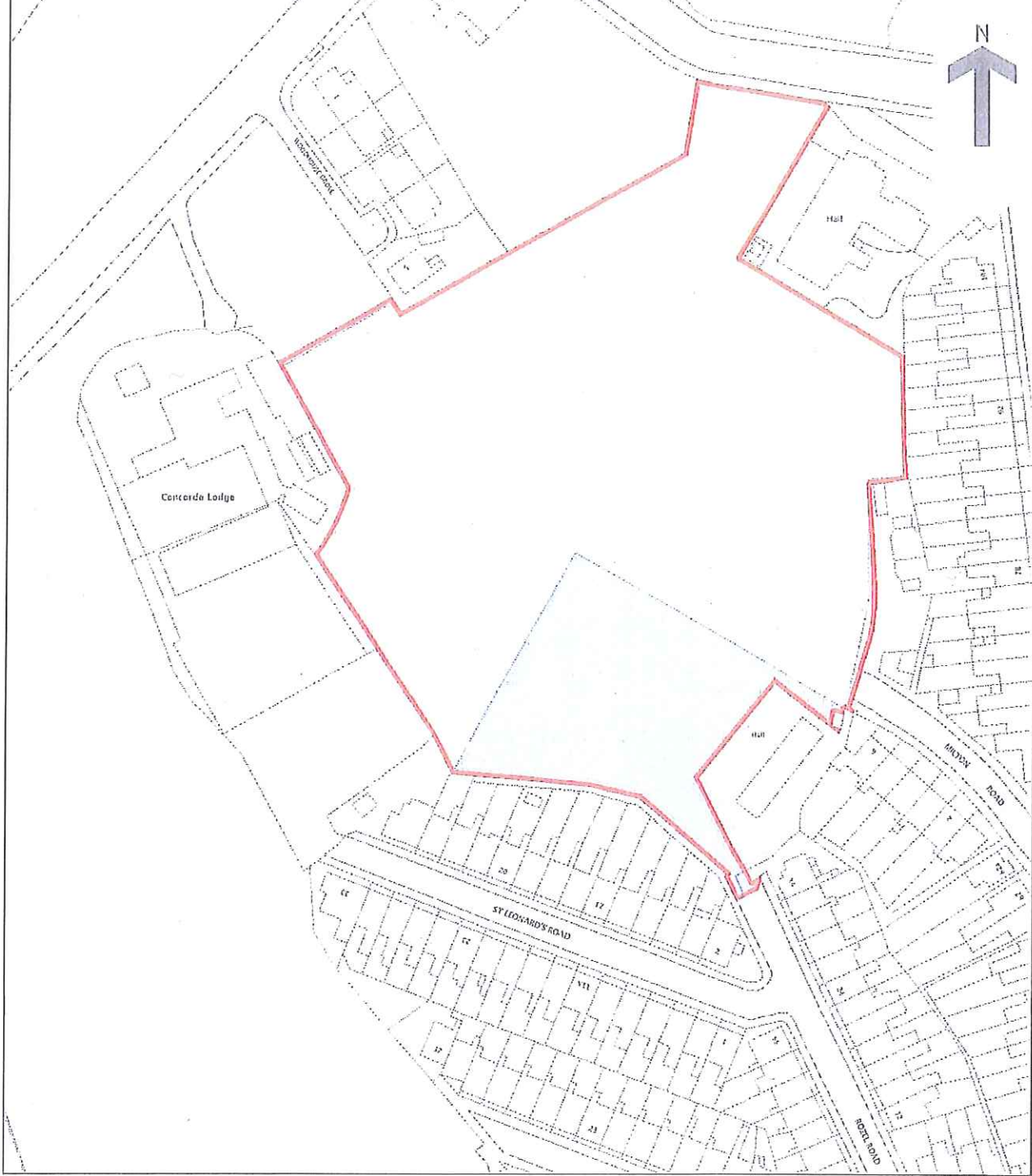

This is a print of the view of the title plan obtained from Land Registry showing the state of the title plan on 09 November 2010 at 16:43:50. This title plan shows the general position, not the exact line, of the boundaries. It may be subject to distortions in scale. Measurements scaled from this plan may not match measurements between the same points on the ground. See Land Registry Public Guide 7 - Title Plans.

This title is dealt with by Land Registry, Gloucester Office.



EXHIBIT A



GREEN IN BLUE

Produced 17.09.2010 from the Ordnance Survey National Geographic Database and incorporating surveyed revision available at this date. © Crown Copyright 2010.

Reproduction in whole or part is prohibited without the prior permission of Ordnance Survey.

Ordnance Survey, the OS Symbol and OS Sitemap are registered trademarks of Ordnance Survey, the national mapping agency of Great Britain.

The representation of a road, track or path is no evidence of a right of way.

The representation of features as lines is no evidence of a property boundary.

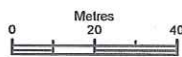

Scale 1:1250

Supplied by: **Stanfords**
Serial number: 00368200
Centre coordinates: 364292.75 176730.75

Further information can be found on the OS Sitemap Information leaflet or the Ordnance Survey web site:
www.ordnancesurvey.co.uk



AREA 2 HA
SCALE: 1:1250
CENTRE COORDINATES: 359813 , 171875

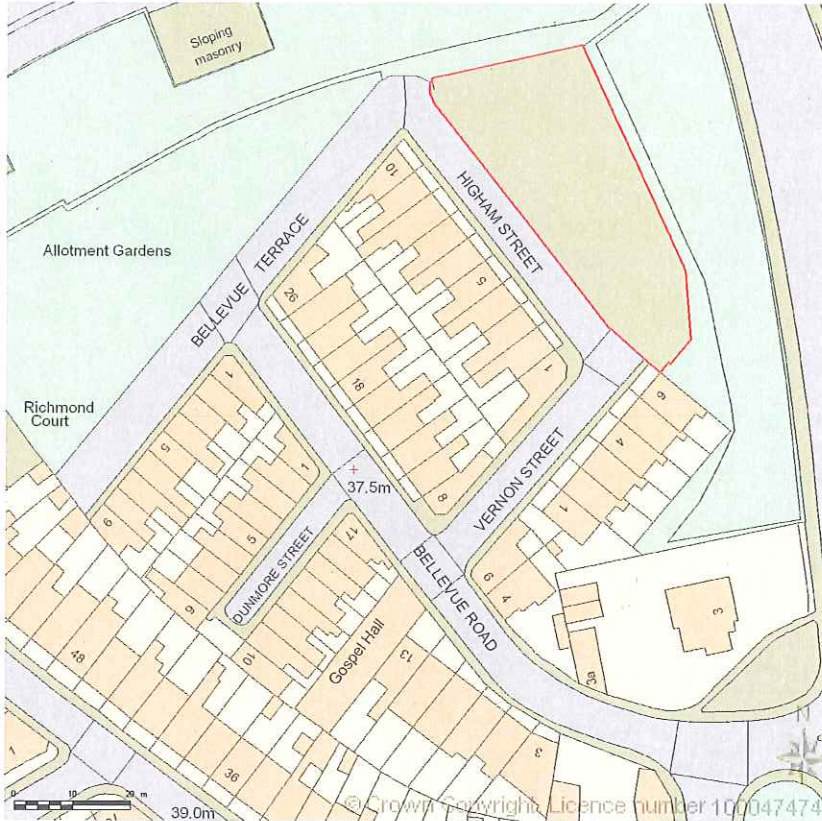

Supplied by Streetwise Maps Ltd
www.streetwise.net
Licence No: 100047474

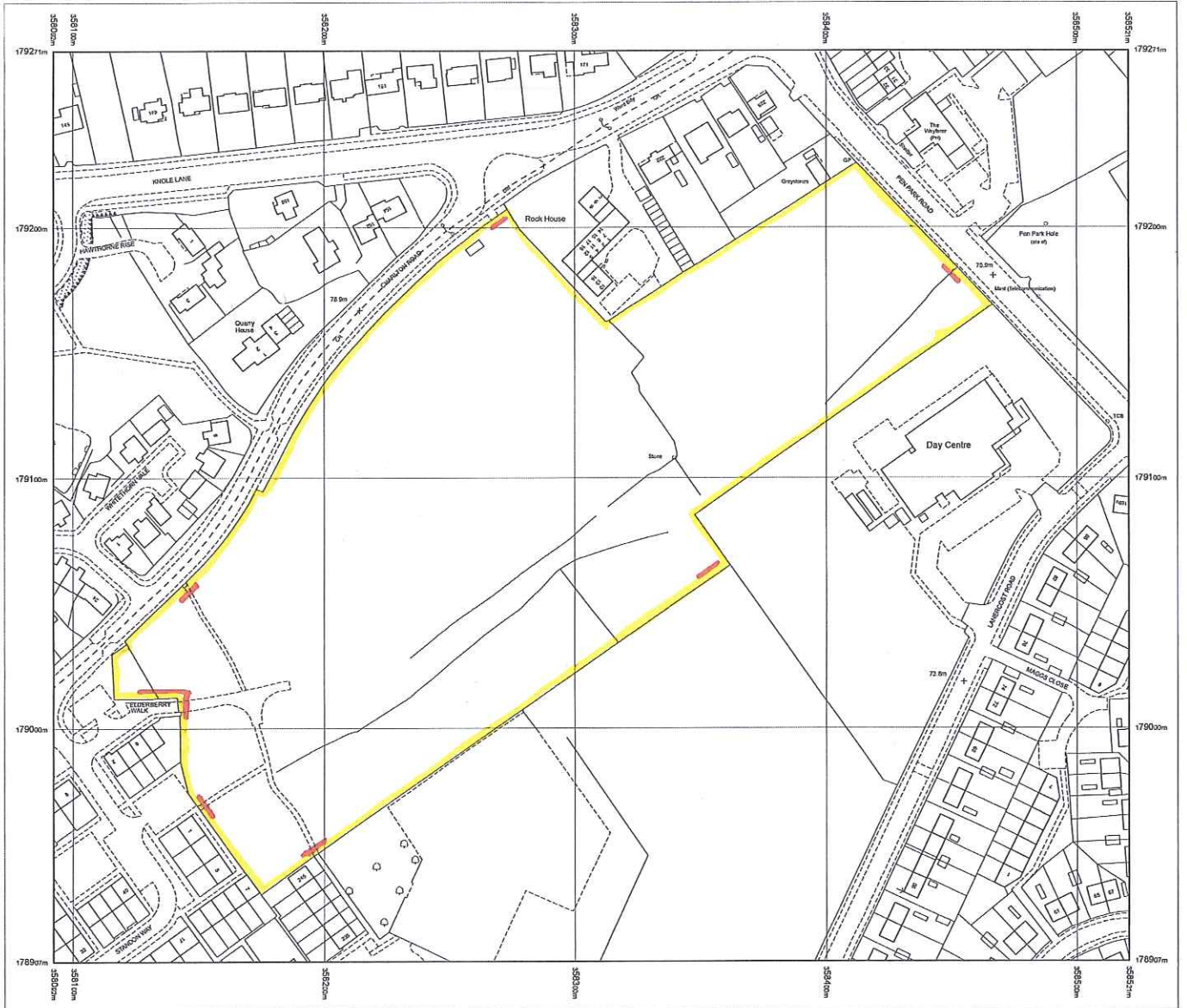

Produced 09.02.2011 from the Ordnance Survey National Geographic Database and incorporating surveyed revision available at this date. © Crown Copyright 2011.

Reproduction in whole or part is prohibited without the prior permission of Ordnance Survey.

Ordnance Survey, the OS Symbol and OS Sitemap are registered trademarks of Ordnance Survey, the national mapping agency of Great Britain.

The representation of a road, track or path is no evidence of a right of way.

The representation of features as lines is no evidence of a property boundary.

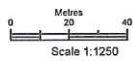

Supplied by: Stanfords
Serial number: 00300100
Centre coordinates: 558306.5 179000.75

Further information can be found on the OS Sitemap Information leaflet or the Ordnance Survey web site: www.ordnancesurvey.co.uk

Exhibit 1
MAP A.

Elderberry

Land Registry
Index map plan

Ordnance Survey map reference ST5576NE
Scale 1:2500
Plan prepared on 18/11/2010 at 00:00:01

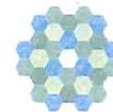

© Crown Copyright. Produced by Land Registry. Reproduction in whole or in part is prohibited without the prior written permission of Ordnance Survey. Licence Number 100026316.

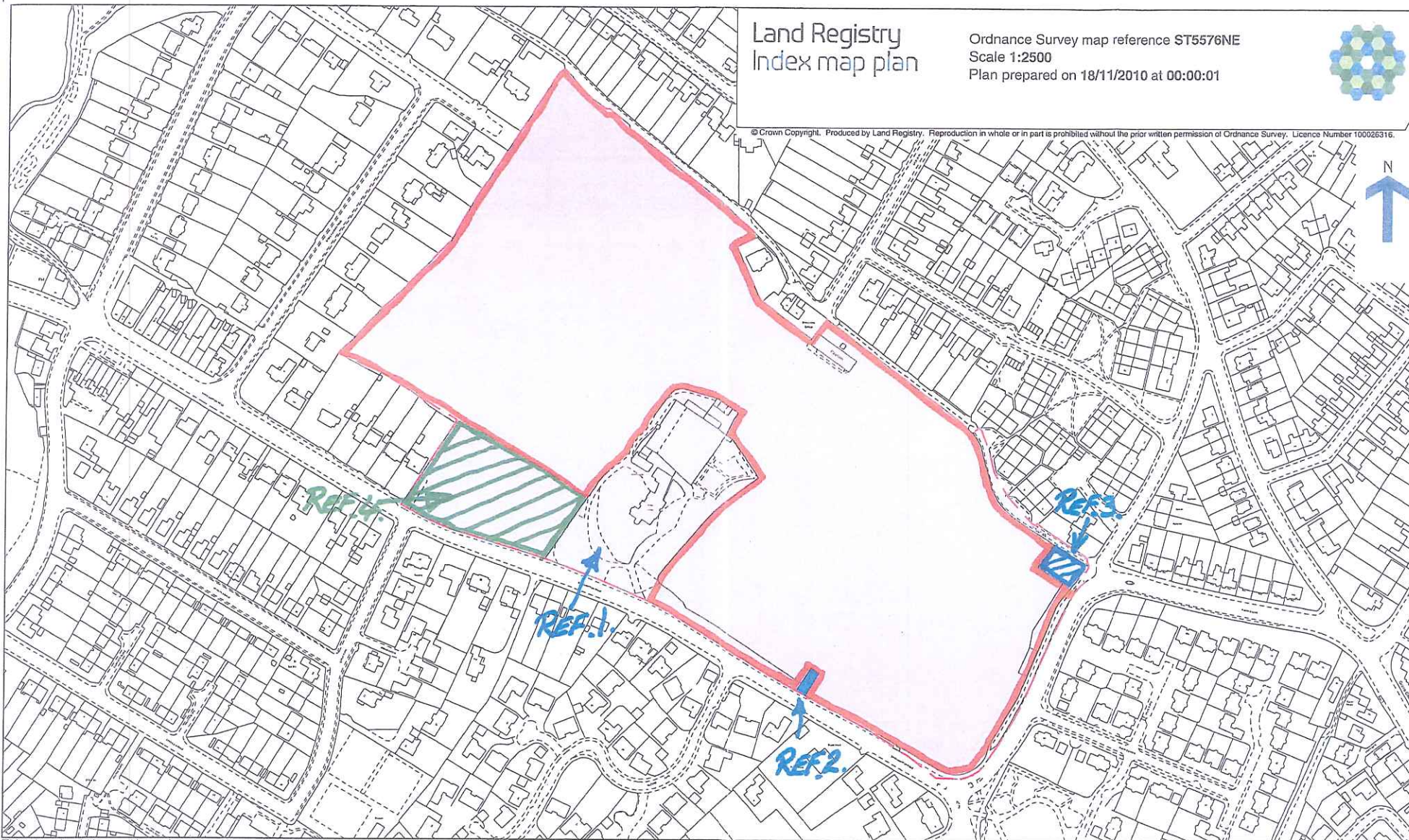

Stobbe Lodge Playing
field

Appendix no: A (X)

This plan should be read in conjunction with result E12MSJB.

This plan shows the general position, not the exact line, of the boundaries. It may be subject to distortions in scale. Measurements scaled from this plan may not match measurements between the same points on the ground. See Land Registry Public Guide 19 - Title Plans and Boundaries.

SEE NOTES
OF EXPLANATION.

PLAN TWO



0640007002